

1

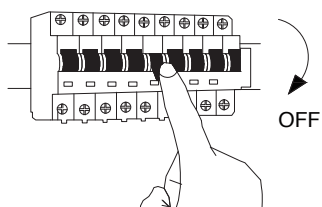

Turn off the general switch

2

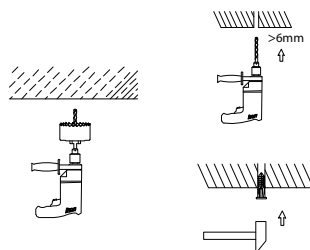

Drill holes & apply plastic anchors

3

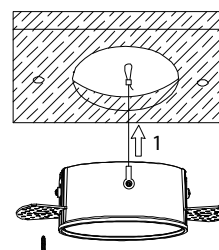

Apply screws

4

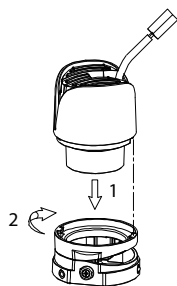

Apply the element in to place

5

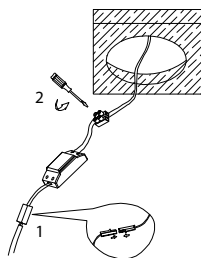

Connect the wires

6

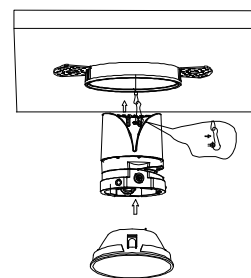

Apply the product in to place

7

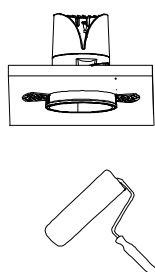

Paint

8

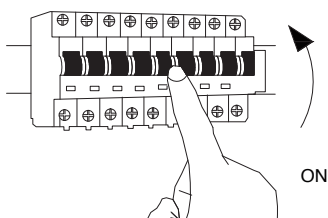

Turn on the general switch

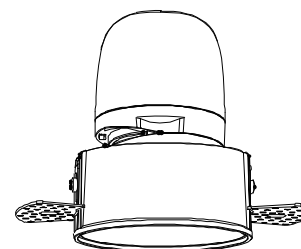

1

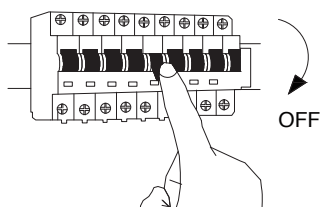

Turn off the general switch

2

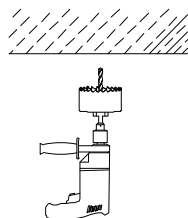

Drill a hole

3

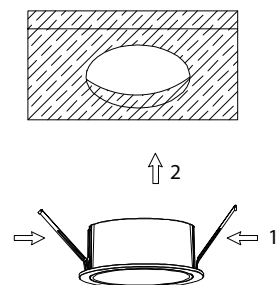

Push inward to apply

4

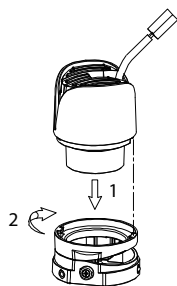

Apply the element in to place

5

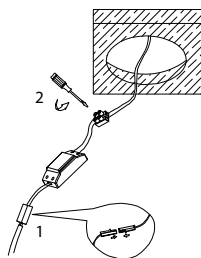

Connect the wires

6

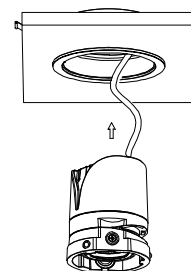

Apply the product in to place

7

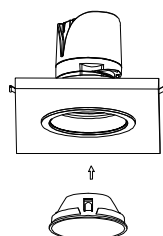

Apply the element

8

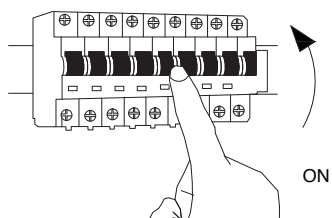

Turn on the general switch

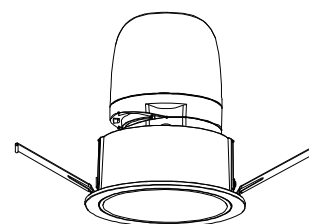

1

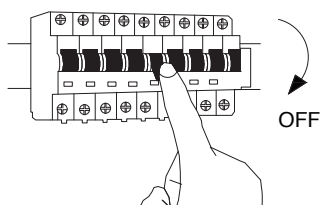

Turn off the general switch

2

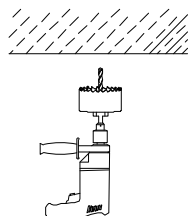

Drill a hole

3

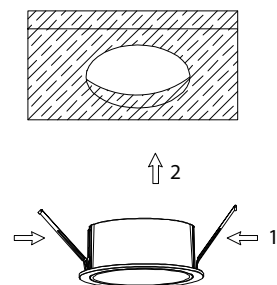

Push inward to apply

4

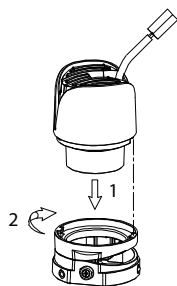

Apply the element in to place

5

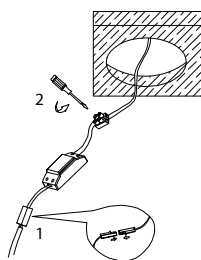

Connect the wires

6

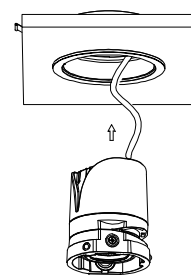

Apply the product in to place

7

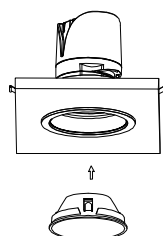

Apply the element

8

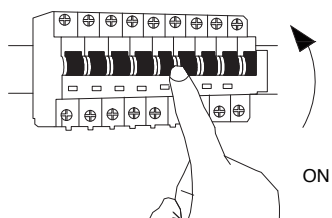

Turn on the general switch

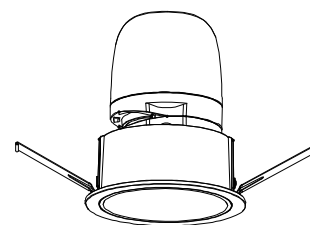

1

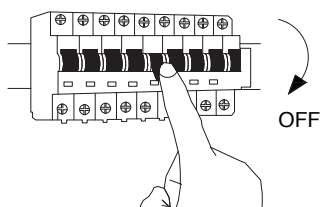

Turn off the general switch

2

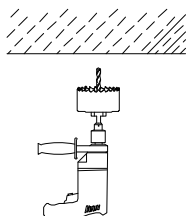

Drill a hole

3

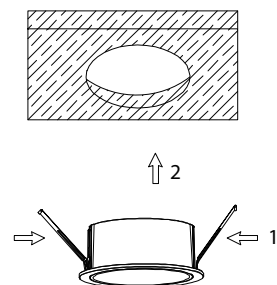

Push inward to apply

4

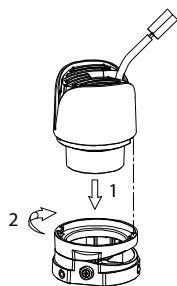

Apply the element in to place

5

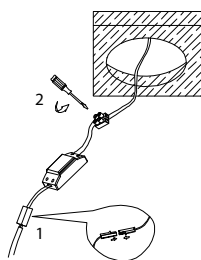

Connect the wires

6

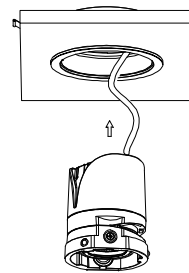

Apply the product in to place

8

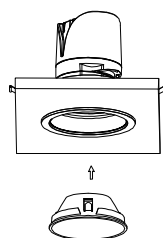

Apply the element

8

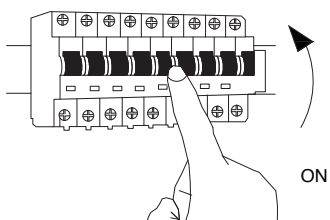

Turn on the general switch

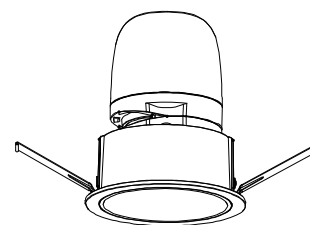

1

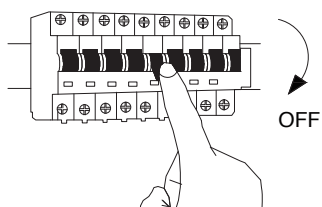

Turn off the general switch

2

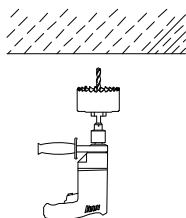

Drill a hole

3

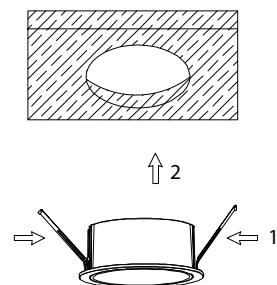

Push inward to apply

4

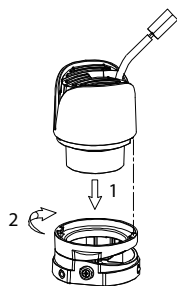

Apply the element in to place

5

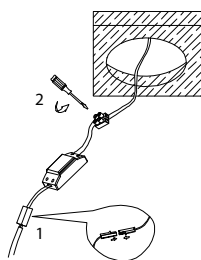

Connect the wires

6

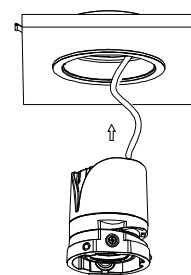

Apply the product in to place

8

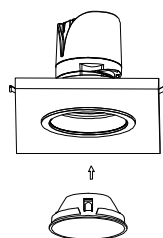

Apply the element

8

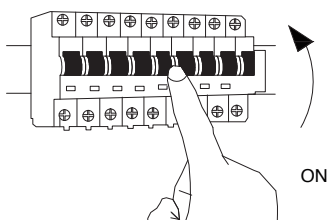

Turn on the general switch

